

## PHOTODIODE DETECTOR

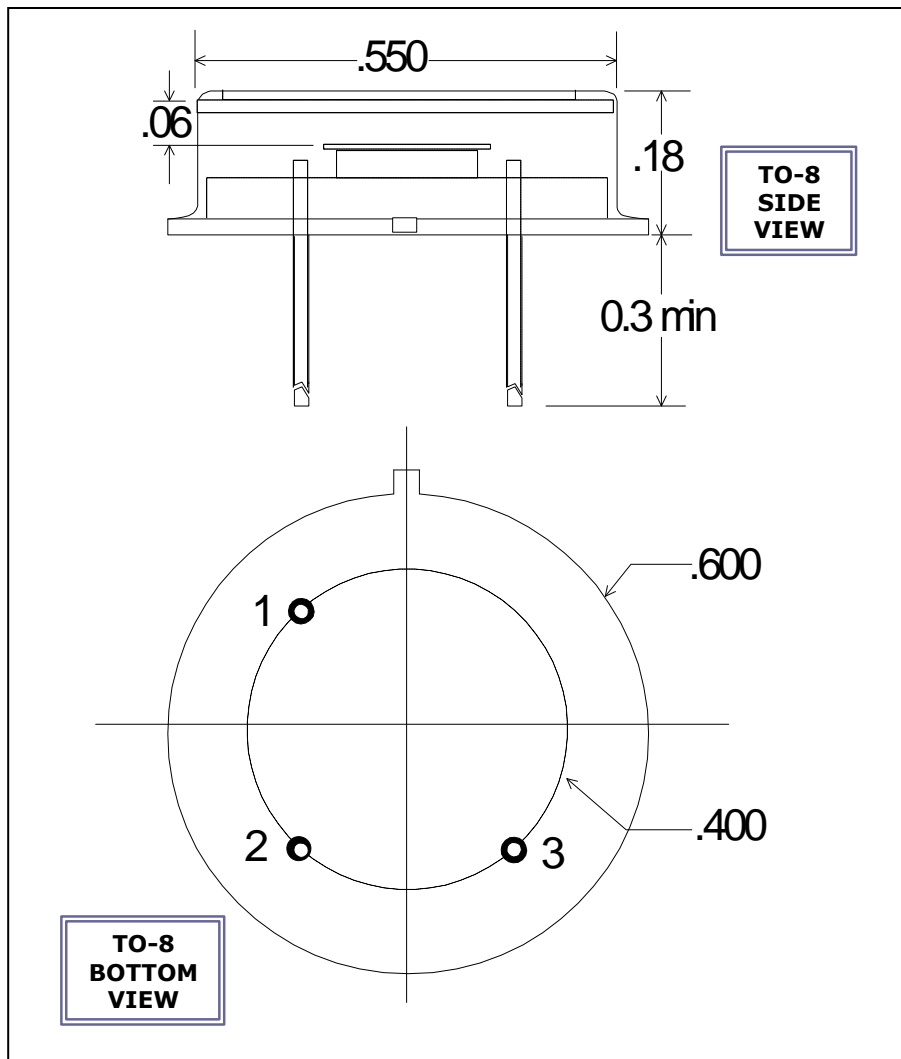

**Part No:** UVS-058

**PIN OUT**

- 1 = ANODE
- 2 = CASE
- 3 = CATHODE

**Note:**  
Dimensions in millimeters

### Application Note

**ELECTRO OPTICAL SYSTEMS** offers room temperature photodiode detectors. The units have state-of-the-art sensitivity and may be supported by accessories such as optical filters (longpass and bandpass), integral preamplifiers, and infrared source assemblies. These units find applications in industrial control systems, gas analyzers, thermal sensors, and general infrared instrumentation.

### SPECIFICATIONS – S-050 UV-enhanced Silicon Photodiode

Active Area (mm)	5.8 x 5.8
Operating Wavelength (nm)	200 - 1100
Shunt Resistance ( $\Omega$ )	200M min ; 500M typ
Shunt Capacitance (pF)	1800 typ
Responsivity (A/W)	0.55 @ 850 nm
NEP ( $W/Hz^{1/2}$ )	$< 1.5 \times 10^{-14}$ @ 850 nm